

8

7

6

5

4

3

2

1

J1 PIN	COLOR	DESCRIPTION	P1 PIN
A	RED	+V	1
B	BLACK	RETURN	2
C	WHITE	GROUND	-

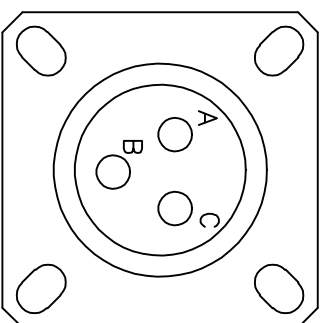

SCALE: 2:1

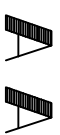

RING LUG #4
INSUL 22-18 Gd

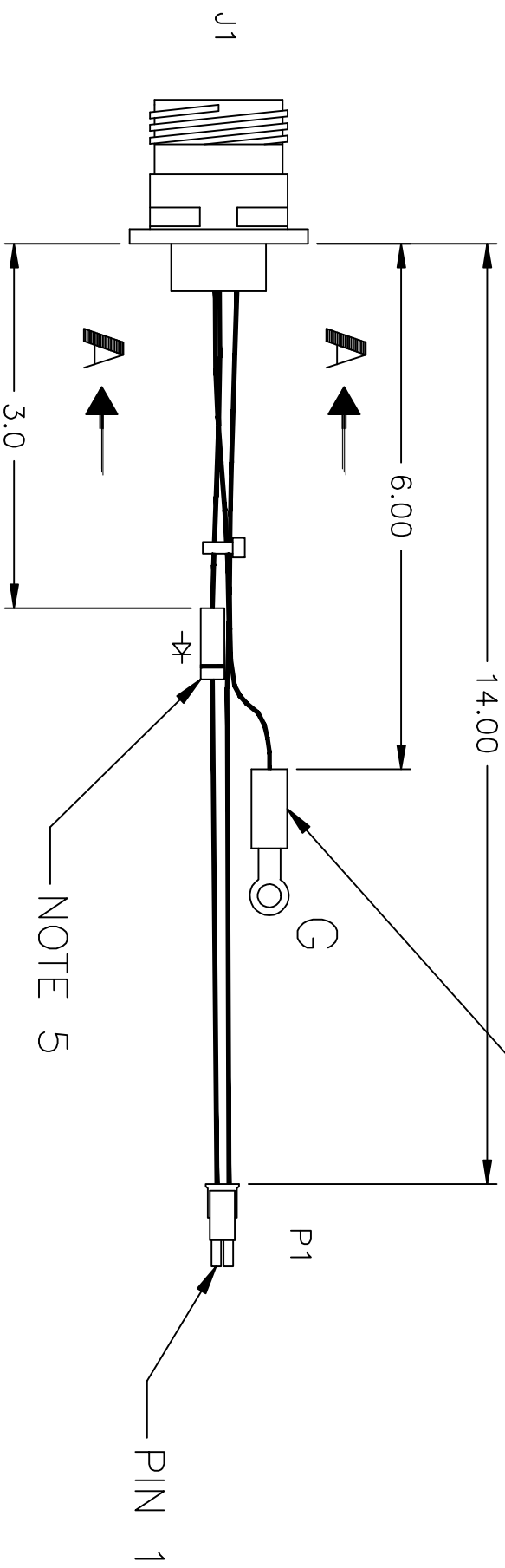

NOTES:

- BAG OR TAG WITH CABLE PART NUMBER & LATEST REVISION.
- J1 CONNECTOR: 3 CONTACT, P/N D38999/20FA98PN, SUPPLIED WITH CRIMP PIN CONTACTS P/N M39029/58-363
- P1 CONNECTOR: 2 CONTACT, MOLEX P/N 43645-0200, WITH CRIMP CONTACTS P/N 43030-0008
- WIRE 20 AWG STRANDED, UL 1015
- ADD DIODE #NTE589 (OBSERVE POLARITY) TO RED WIRE THEN COVER WITH SHRINK SLEEVING.
- J1 MATING CONNECTOR D38999/26FA98SN AND M85049/38S9N CABLE CLAMP

CHANGE HISTORY		APPROVAL
FILE INDEX	DESCRIPTION	DATE
1	INITIAL RELEASE	
2	ADDED DIODE, NOTE 5	
3	J1 WAS D38999/20WA98PA	11/2/10
4	J1 WAS D38999/20WA98PN	11/19/10

UNLESS OTHERWISE SPECIFIED DIMENSIONS ARE IN INCHES AND APPLY AFTER FINISH		DRAWN N MATERA		DATE 9/24/09	
TOLERANCE ON SURFACE ROUGHNESS		CHECKED		ENGINEER	
DECIMALS ANGLES		DRAFTING		MANUF	
± .XX = .01		± .X = .01		APPROVED	
± .XXX = .005		± .X = .005		QA	
MATERIAL NOTED		FINISH		SCALE 1 : 1	
VT150XB M		SEE NOTES		SIZE CAGE CODE	
VT121XB M				B OZE75	
VT094XB M				DWG NO.	
VT104XB M				354-0249	
USED ON				REV	
APPLICATION				4	



VARTECH SYSTEMS
ASSEMBLY, POWER CABLE,
38999, 3 COND, INT

8

7

6

5

4

3

2

1