

VT170C2



VARTECH SYSTEMS INC.

Solutions for Demanding Applications

17" Open-Frame Chassis Mount LCD Display



This SXGA resolution 17.0" flat panel display is housed in an all aluminum open-frame chassis and was designed as a space saving low profile assembly with an easy drop-in design for use in Kiosks, Machine Automation and Industrial Control applications. These displays are auto sync compatible with various VESA video standards.

SPECIFICATIONS

Display Size	17.0
Panel Type	TFT Active
Native Resolution	SXGA (1280 x 1024)
Active Display Area	13.30" (w) x 10.64" (h) / 337.9mm(w)x 270.3mm(h)
Viewing Angle	Left / Right: 85°/85°, Up / Down: 85°/85°
Contrast Ratio	1000:1
Brightness	380 nits (cd/m2)
Pixel Pitch	.264mm (w) x .264mm (h)
Colors	16.8M
Back Light	50,000 Hours Half Life
Power Consumption	35 Watts @ 115VAC, 4 Watts Sleep Mode
Power Source	90-264VAC Universal, Optional: 12VDC or 24VDC
Video Input	VGA - 0.7Vp-p / 75 ohm, Composite - 1.0Vp-p / 75 ohm
Input Connectors	HD15(F), DVI-I, RCA (NTSC/PAL), 5 Pin Mini Din (S-Video)
Sync	TTL Separate H&V, Combined, SOG
Temperature	Operating: 0 to 50° C, Storage: -20 to 60° C, Optional: Operating: -20°C or -40°C
Altitude	Operating: up to 10,000 ft, Storage: up to 40,000 ft
Rear Enclosure	Black Powder Coated Aluminum
Touchscreen	Optional: Resistive, Capacitive, Armor Touch
Touchscreen Interface	Serial or USB
Warranty	2 years

FEATURES

- ◆ Bright Active Matrix TFT Display
- ◆ HD15(F), DVI-D Pin, RCA, Mini Din
- ◆ High Contrast Ratio
- ◆ Low Power Consumption
- ◆ Anti-Reflective Protective Faceplate
- ◆ Optional Touch Systems
- ◆ VGA to SXGA
- ◆ Black Powder Coated Aluminum Rear Enclosure

Marks of Conformity:
 FCC47 CFR part 15, subpart B
 EMC: EN 55022:2006, EN 55024:1998, CISPR 22:2005, CISPR 24:1997
 Canada: ICES-003
 Australia/New Zealand: AS/NZS CISPR 22
 CE
 RoHS
 WEEE

*Supports all VESA standard video formats

CONTACT

HEADQUARTERS
11529 Sun Belt Ct.
Baton Rouge, Louisiana 70809

Phone 800.223.8050
International
001.225.298.0300
Fax 225.297.2440

E-mail
sales@vartechsystems.com
Website
www.vartechsystems.com

OPTIONS

- Touch Screen: Capacitive, Resistive Touch, Armor Touch
- Optical Bonding for added Shock & Vibration protection and/or reduced solar reflectivity
- Heaters & Thermostat for extended Operational Temperature -20°C or -40°C
- Inputs: Component Video YPbPr/SD or Component Video YCbCr
- HD15(M) to 5xBNC(F) Interface Cable
- Private Label for OEM/VAR Applications
- 12VDC or 24VDC Power
- 120 to 370 V DC

Mechanical Drawing

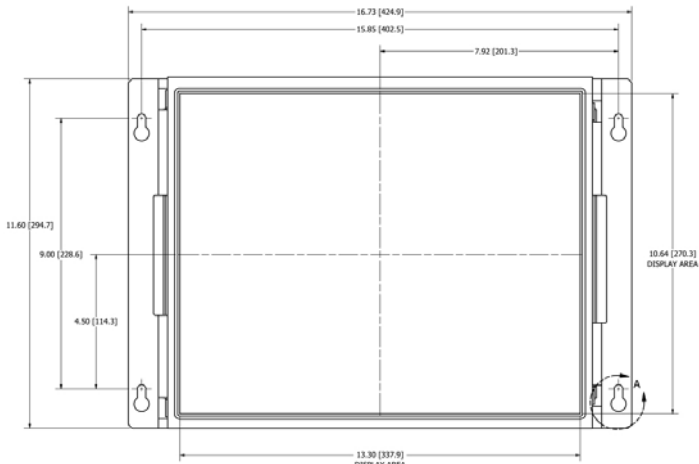

FRONT VIEW

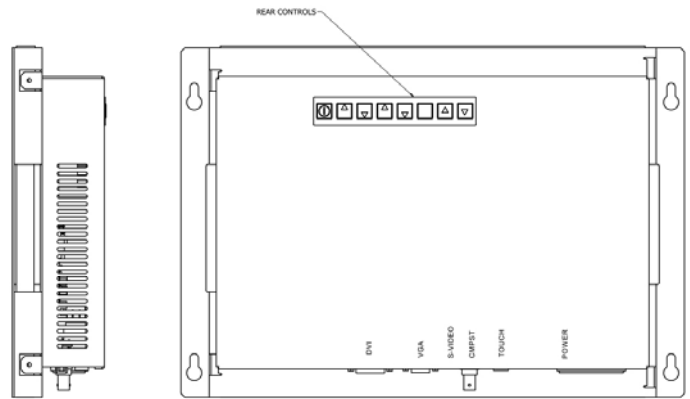

REAR VIEW

SIDE VIEW

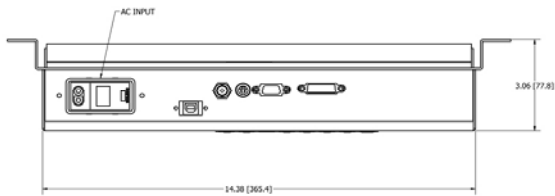

I/O PNL VIEW
SCALE 1:1.5

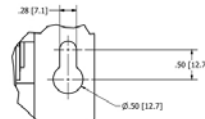

DETAIL A
SCALE 1.33 : 1

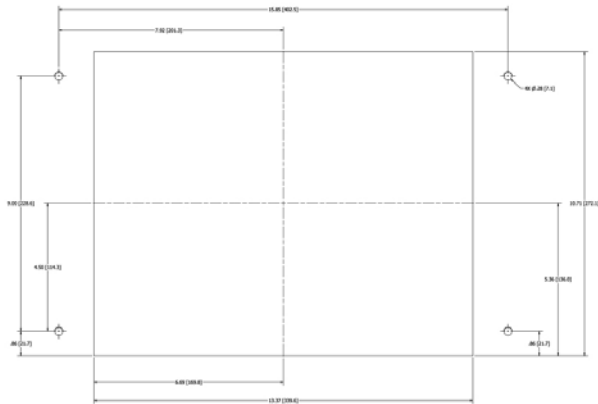

DESIGN	REV	6/21/2010	VARTECH SYSTEMS	
CHECKED	DATE		TITLE	
QA			OUTLINE DRAWING, VT170C2	
ENG			SIZE	TOLERANCES
VT170C2	APPROVED		D	0.005 - 0.010
USED ON	PARTIAL		DRG NO	601-0356-R1
APPLICATION			TRNG	REV
				1
				Sheet 1